



MULTIPURPOSE WATERTIGHT LUMINAIRE FOR  
ENGINE ROOMS, WORK SHOPS, STORES,  
PASSAGE WAYS AND OUTDOOR AREAS

|                         |  |
|-------------------------|--|
| <b>Design</b>           | According to rules of maritime classification societies and relevant standards |
| <b>Housing</b>          | Galvanized steel, seamless deep drawn, powder coated white (RAL9016)           |
| <b>Cover</b>            | Clear or opal polycarbonate, impact-proof, UV resistant                        |
| <b>Mounting</b>         | Different systems available, see next page                                     |
| <b>Cable entry</b>      | Max. 4 cable glands M20  |
| <b>Protection class</b> | IP67   |
| <b>Light source</b>     | Linear LP LED modules with anti-glare cover                                    |
| <b>Wattage</b>          | Max. 20 W / HO: max. 30 W  |
| <b>CCT (color)</b>      | 4,000 K  |
| <b>Luminous flux</b>    | 2,200 lm / HO: 4,500 lm (clear cover)  |
| <b>CRI</b>              | ≥ 80   |
| <b>Voltage</b>          | 220–240 V AC   |
| <b>Frequency</b>        | 50–60 Hz   |

#### PART NO.

|          |                |
|----------|----------------|
| TL40S    | 5105012000-xxx |
| TL40S HO | 5105012900-xxx |

#### SPARE PARTS

#### PART NO.

|                   |            |
|-------------------|------------|
| Clear cover TL40S | 7112001100 |
| Opal cover TL40S  | 7112001900 |
| Clamps (6 pcs)    | 7106000300 |

#### EXTRAS

- > TL40S Plus: –40°C ... +60°C
- > Stainless steel housing
- > 120 V AC execution
- > 24 V DC execution
- > Dimmable
- > LED mounting tray as refit for TL40 fluorescent types
- > Exterior connection box
- > Emergency battery back-up
- > Different color temperatures
- > Different cable glands
- > IP66



**Type: Bolt kit 8 mm**

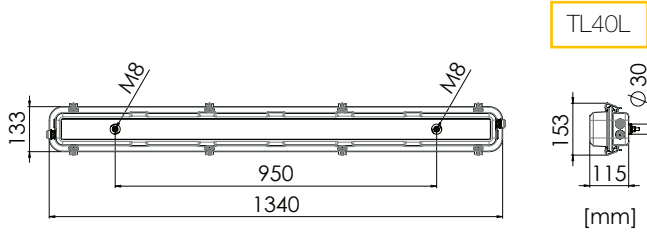
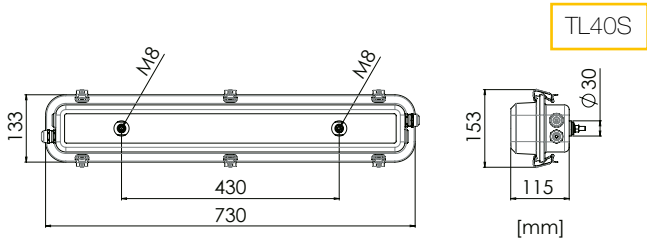

Type: Bolt kit 8 mm



**Type: LP160**

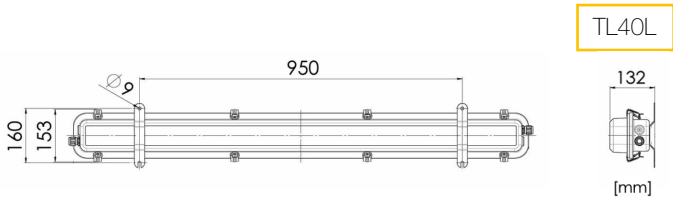
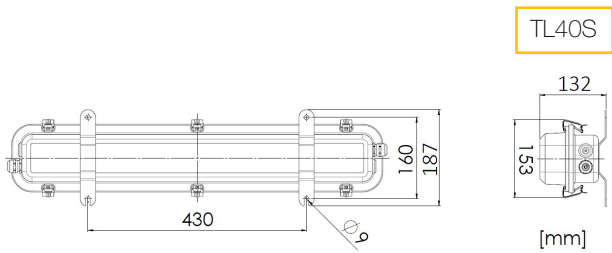

Type: LP160



**Type: LP GL**

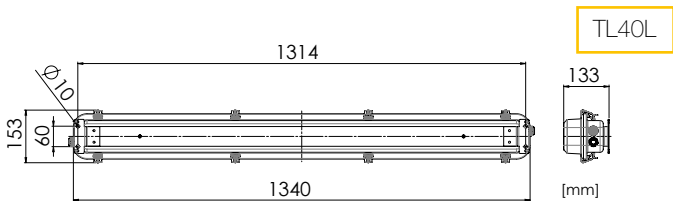
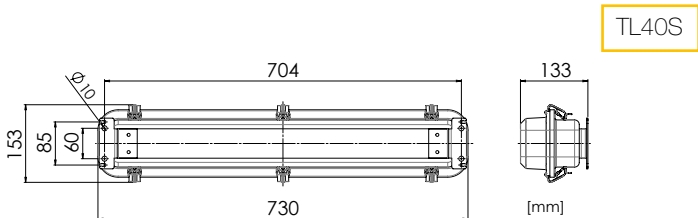

Type: LP GL



Type: Pipe brackets

