



DECORATIVE STEP LIGHT, LED, FOR STAIRWAYS,
PASSAGE WAYS, INDIRECT AND EFFECT LIGHTING

| | |
|-----------------------------|--|
| Design | According to rules of maritime classification societies and relevant standards |
| Housing | Stainless steel |
| Decorative ring | Stainless steel, brushed |
| Cover | Glass lens |
| Mounting | 2 springs for wall thickness max. 16 mm |
| Connection type | 150 mm connection cable |
| Protection class | IP44 |
| Weight | 0.05 kg |
| Light source | Single LP LED module |
| Wattage | Max. 1 W |
| CCT (color) | 2,700 K |
| CRI | ≥ 80 |
| Current | 350 mA |
| Electrical execution | Driver required (not included) |

PART NO.

DL01

5303009000-001

★ EXTRAS

- > Dimmable
- > Different color temperatures
- > Connection type unit according to specific application
- > Different finishes or colors in accordance with RAL or NCS

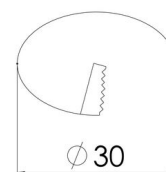
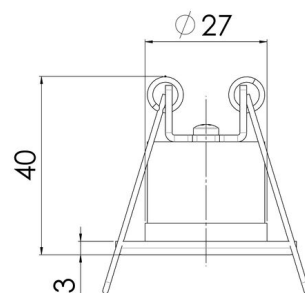
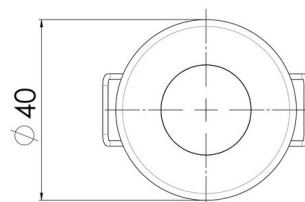

[mm]

