



FLAT LED DOWNLIGHT FOR BATHROOMS
AND ACCOMMODATION AREAS

Design	According to rules of maritime classification societies and relevant standards
Housing	Galvanized steel, powder coated white (RAL9016)
Decorative ring	White/chrome
Cover	Opal polycarbonate
Mounting	Fixing springs for ceilings max. 10 mm
Connection type	Connection cable with Ensto 2-pole plug
Protection class	IP44
Weight	0.2 kg
Light source	LED
Wattage	Max. 3 W
CCT (color)	2,700 K
CRI	≥ 80
Current	350 mA
Electrical execution	Driver required (not included)

PART NO.

DL100 white	5404000400-001
DL100 chrome	5404000400-002

EXTRAS

- > Different connectors
- > Different transformers
- > Different color temperatures
- > Different finishes

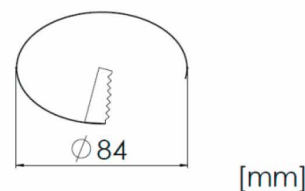
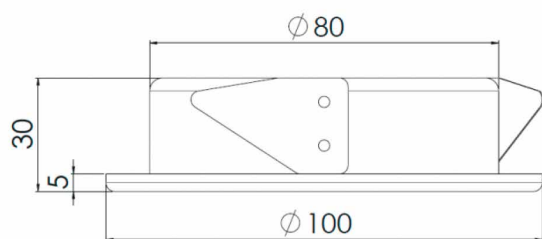

[mm]

