



FLAT LED FURNITURE LIGHT

## PART NO.

DL70 white	5303003200-002
DL70 chrome	5303003200-005

## ★ EXTRAS

> Different connectors

<b>Design</b>	According to rules of maritime classification societies and relevant standards
<b>Housing</b>	Plastic
<b>Decorative ring</b>	White / chrome
<b>Cover</b>	Satin
<b>Mounting</b>	Spring clips for ceilings max. 20 mm
<b>Connection type</b>	2000 mm lead with mini male plug for drilling holes Ø 8 mm
<b>Protection class</b>	IP20 / IP44 in conjunction with ceiling
<b>Weight</b>	0.12 kg
<b>Light source</b>	Cluster LED module, not dimmable
<b>Wattage</b>	Max. 2.6 W
<b>CCT (color)</b>	3,000 K
<b>Luminous flux</b>	170 lm
<b>CRI</b>	≥ 80
<b>Voltage</b>	110–220 V AC
<b>Frequency</b>	50–60 Hz

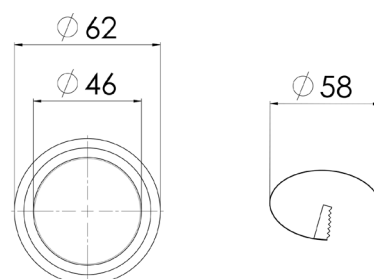

[mm]

