



ADJUSTABLE LED READING LIGHT WITH SWITCH
FOR CABINS AND ACCOMMODATION AREAS
WITH INTEGRATED USB CHARGER

Design	According to rules of maritime classification societies and relevant standards
Housing	Stainless steel, brushed
Switch	1-pole switch
Swivel range	350°
Mounting	4 mounting holes, Ø 4.5 mm
Cable entry	30 mm x 15 mm
Protection class	IP20
Weight	0.7 kg
Light source	LED
Wattage	Max. 1 W
CCT (color)	2,700 K
Voltage	120–240 V AC
Frequency	50–60 Hz

PART NO.

WL100Q

5127012400-002

EXTRAS

- > Different finishes
- > Different color temperatures

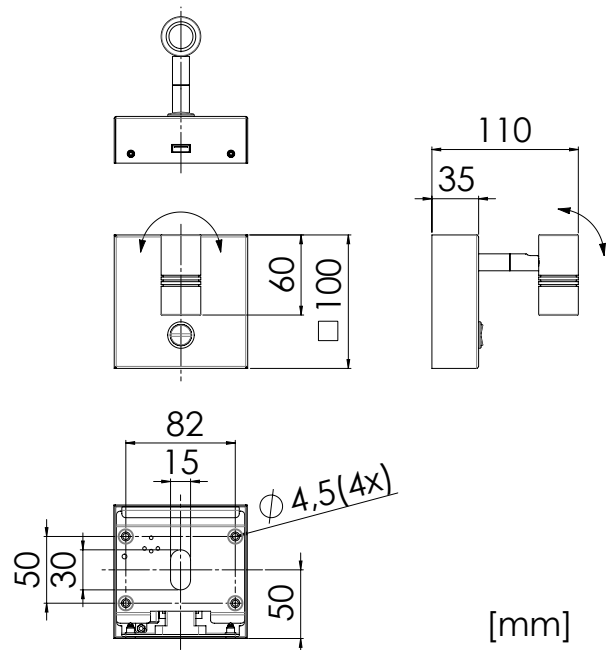

[mm]

