



ADJUSTABLE LED READING LIGHT WITH SWITCH
FOR CABINS AND ACCOMMODATION AREAS
WITH INTEGRATED USB CHARGER

Design	According to rules of maritime classification societies and relevant standards
Housing	Stainless steel, brushed
Switch	1-pole switch
Mounting	4 mounting holes, Ø 4.5 mm
Cable entry	30 mm x 15 mm
Protection class	IP20
Weight	0.5 kg
Light source	LED
Wattage	Max. 1 W
CCT (color)	2,700 K
Luminous flux	90 lm
Voltage	120–240 V AC
Frequency	50–60 Hz

PART NO.

WL30Q

5127012100-002

★ EXTRAS

- > Different finishes
- > Different color temperatures

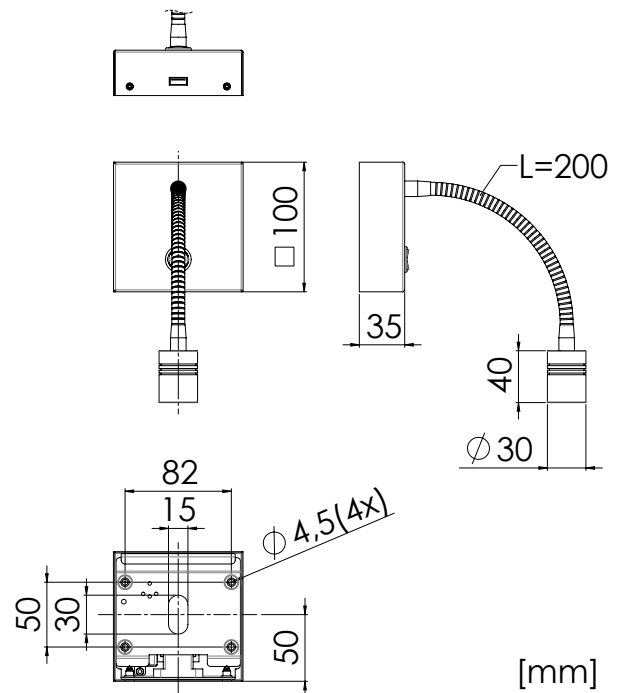

[mm]

