

## RECESSED CEILING LUMINAIRE

## DE16

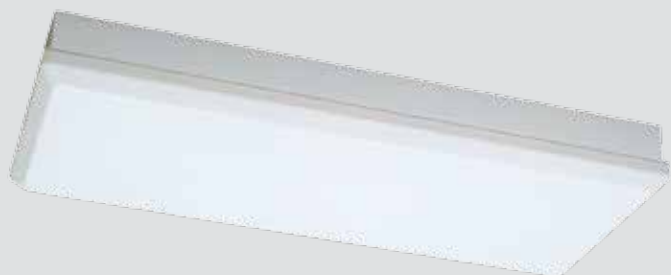

3



RECESSED MOUNTED CEILING LUMINAIRE  
FOR PASSAGE WAYS, ACCOMMODATION AREAS  
AND CORRIDORS

<b>Design</b>	According to rules of maritime classification societies and relevant standards
<b>Housing</b>	Galvanized steel, powder coated white (RAL9016)
<b>Diffuser</b>	Opal polycarbonate, impact-proof
<b>Mounting</b>	4 mounting holes, Ø 5.2 mm
<b>Cable entry</b>	4 inlets for cables max. Ø 13 mm
<b>Protection class</b>	IP30 / IP44 in conjunction with ceiling
<b>Voltage</b>	220-240 V AC
<b>Frequency</b>	50-60 Hz

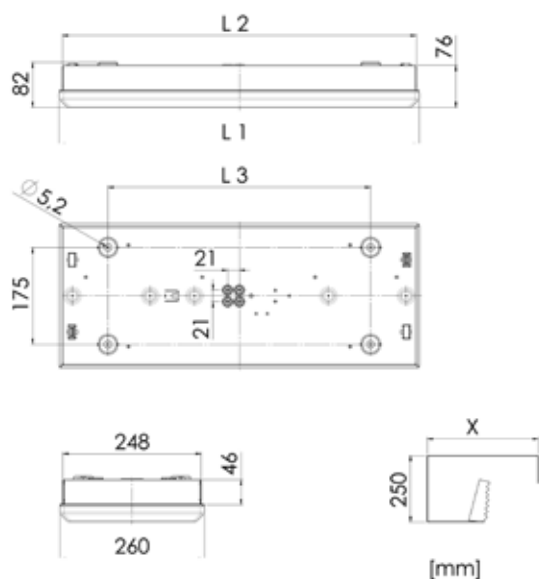

## ★ LED SOLUTION

DE16S	5111008610-xxx
DE16L	5111008710-xxx
Light source	Linear LP LED modules
Wattage	Max. 20 W / max. 40 W
CCT (color)	3,000 K or 4,000 K
Luminous flux	DE16S: 1,500 lm DE16L: 3,100 lm
CRI	≥ 80
Weight	3.1 kg (DE16S) 5.5 kg (DE16L)

## ✎ FLUORESCENT SOLUTION

DE16 2x 18 W	5111000100-046
DE16 2x 36 W	5111000800-023
Light source	T8 fluorescent tubes (not included)
Wattage	2x 18 W 2x 36 W
Lamp base	G13
Weight	3.1 kg (2x 18 W) 5.5 kg (2x 36 W)

## 🔧 SPARE PARTS

## PART NO.

DE16S cover	7112000600
DE16L cover	7112000700

## ★ EXTRAS

- > 120 V AC execution
- > 24 V DC execution
- > Dimmable
- > Emergency battery back-up
- > Different fitting systems

TYPE	L1	L2	L3	X
DE16S	648	634	475	635
DE16L	1260	1244	950	1245