

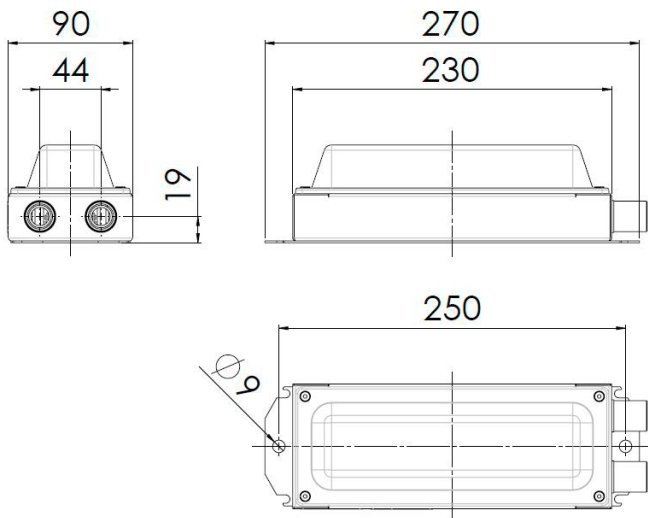

SMALL MULTIPURPOSE LUMINAIRE FOR MACHINERY SPACES, WORKSHOPS, STORES AND EMERGENCY SIGN LIGHT









[mm]

MB6.105.0021.00

STANDARD CONFIGURATION

Housing/Cover	Galvanized steel, powder coated white (RAL9016), with opal polycarbonate cover
Mounting	2 holes, Ø 9 mm
Cable entry	2 cable glands
Protection class	IP67
Light source	LED module
Wattage	4 W
Luminous flux	350 lm
CCT (color)	4,000 K
CRI	≥ 80

AVAILABLE FEATURES

	EMI proof
	Shock proof
	Vibration resistant
	NVG compatible
	Adaptation light
	Multi-circuit

YOUR REQUIREMENTS

Please contact us for different configurations or further information on this luminaire type. Based on your requirements, the final part number will be provided.